

Single Axle Air Suspension System

# MORryde Air1

OWNERS MANUAL

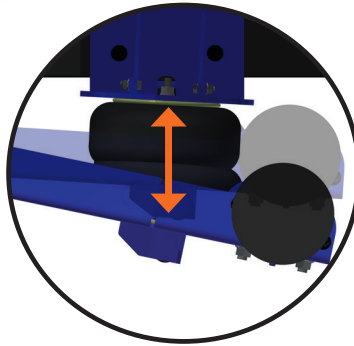
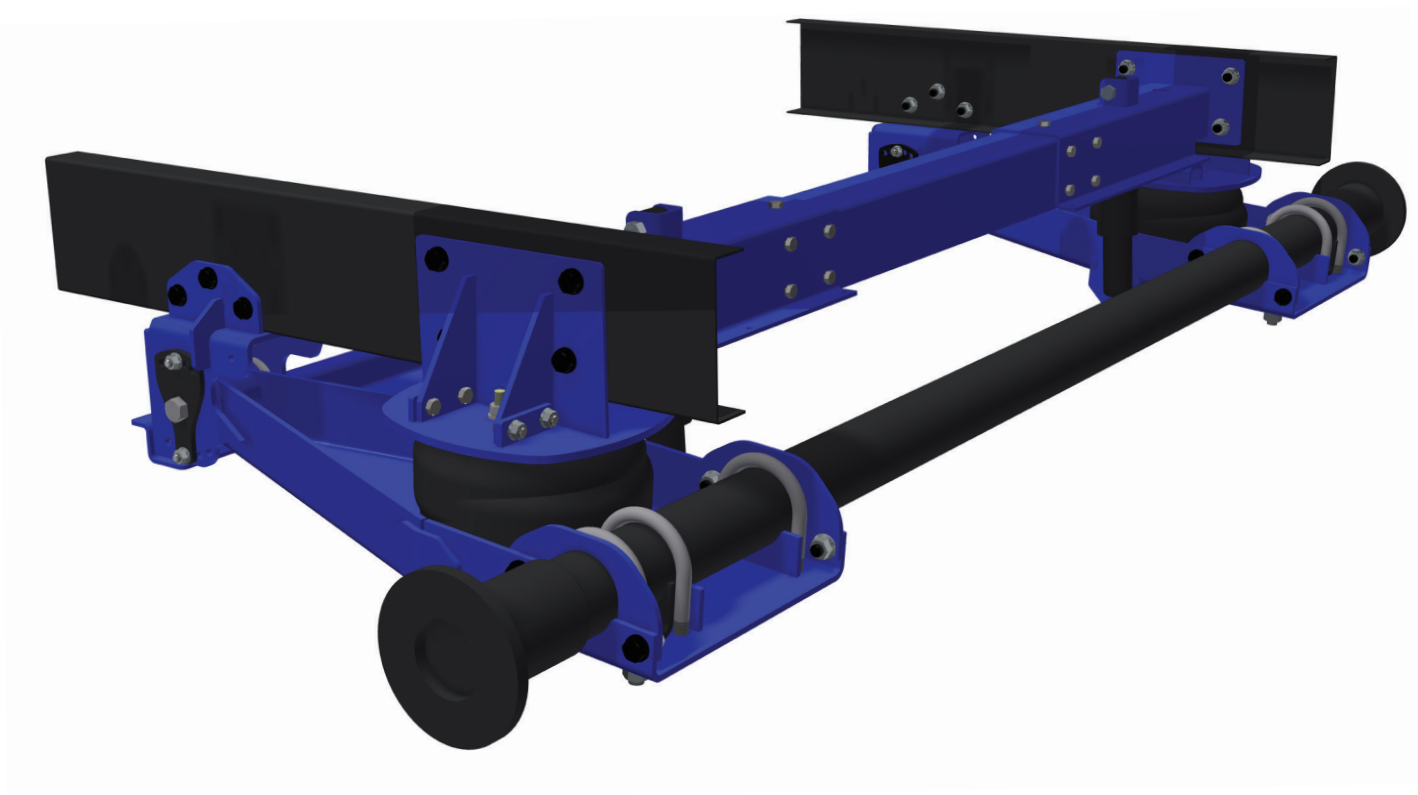

Above. Beyond. Always.



Above. Beyond. Always.



Parts List .....	3
Parts List Assembly.....	4
<b>Introduction</b>	
• Guidelines for Adding or Removing Air Pressure.....	5
<b>Pneumatic Plumbing Details</b> .....	6
<b>Powerpack Details</b> .....	7
<b>Preparation</b>	
• Product and Safety Information.....	8
• Use of Manual .....	9
• Compatibility.....	9
• Pretravel Inspection .....	9
• Tow Rating Checks .....	9
<b>Operating Instructions</b>	
• System Mobile App User Guide.....	10
– Remote .....	11
– Remote Presets .....	13
– iOS App.....	13
– Android App .....	15
<b>Maintenance</b> .....	18
<b>Troubleshooting Guide</b>	
• Replacing Batteries in the Remote.....	19
• FCC and Industry Canada Information to User.....	19
• Error Codes.....	20
• Finding Air Leaks.....	21
• Fixing Leaks on Barbed Fittings.....	21
• Cutting Air Lines .....	21
• Fixing Leaks on PTC Fittings .....	22
• Manual Control Using the Schrader Valve.....	22
• Axle Thrust Adjustment.....	23
• Flat Tire Change Procedure.....	25
• Installing Wheel Covers .....	26
<b>Getting Help</b>	
• YouTube Video Suggestions .....	27
• Limited Warranty and Return Policy .....	27
• Replacement Parts Information.....	27
• Contact Information.....	27

# PARTS LIST

## TORQUE CHART:

BOLT SIZE	MATERIAL GRADE PLATED	TORQUE ft-lbs
3/8-16	8	40
1/2-13	8	80
9/16-18	5	75
5/8-11	8	190

## MRA35-001

PARTS LIST		
ITEM	QTY	PART NUMBER
1	22	WHIZ NUT 1/2"-13
2	22	FLANGE BOLT 1/2"-13 X 1-1/4"
3	1	FRAME HANGER CAPTURE PLATE- LH
4	1	FRAME HANGER CAPTURE PLATE- RH
5	1	MRA136-004; POWERPACK-V2
6	1	MRA136-005; FOB
7	1	UO136-3235-130 INCHES

## MRA22-001

PARTS LIST		
ITEM	QTY	PART NUMBER
1	1	TRAILING ARM - LH
2	1	TRAILING ARM - RH
3	1	ROCKWOOD AXLE BY DEXTER
4	1	SPRING CARRIER LH
5	4	TRAILING ARM BRACE
6	9	BOLT 1/2"-13 X 1-1/4"
7	6	U-BOLT 9/16-18
8	2	BOLT 5/8"-11 X 5-1/2"
9	2	5/8"-11 LOCK NUT
10	1	PIVOT BRKT. X-MEMBER
11	4	FLANGE WHIZ NUT 3/8"-16
12	12	U-BOLT LOCK NUT 9/16"-18
13	2	UPPER SHOCK MOUNT BOLT
14	4	BOLT 3/8"-16 X 1"
15	2	AIR SPRING
16	4	PIVOT BOLT WASHER
17	2	LOOP SHOCK
18	1	PIVOT BRACKET - RH
19	1	PIVOT BRACKET - LH
20	1	SPRING CARRIER - RH
21	4	AIR SPRING BOLT 10X1.5X25
23	4	LOCK NUT 1/2"-13
24	2	FLAT WASHER 1/2"
25	2	BOLT 1/2"-13 X 3-1/2"
26	13	FLANGE WHIZ NUT 1/2"-13
27	1	SCHRADER VALVE UO136-3236
28	1	1/4" UNION ELBOW UO135-3238
29	1	STREET T UO135-3239
30	1	1/4" NYLON AIR HOSE UO136-3235
31	1	UNION T UO136-3237
32	2	PINCH POINT DECAL UO162-063
33	1	RIDE HEIGHT DECAL UO162-061
34	1	RIDE HEIGHT DECAL UO162-062



Above. Beyond. Always.

MRA35-001

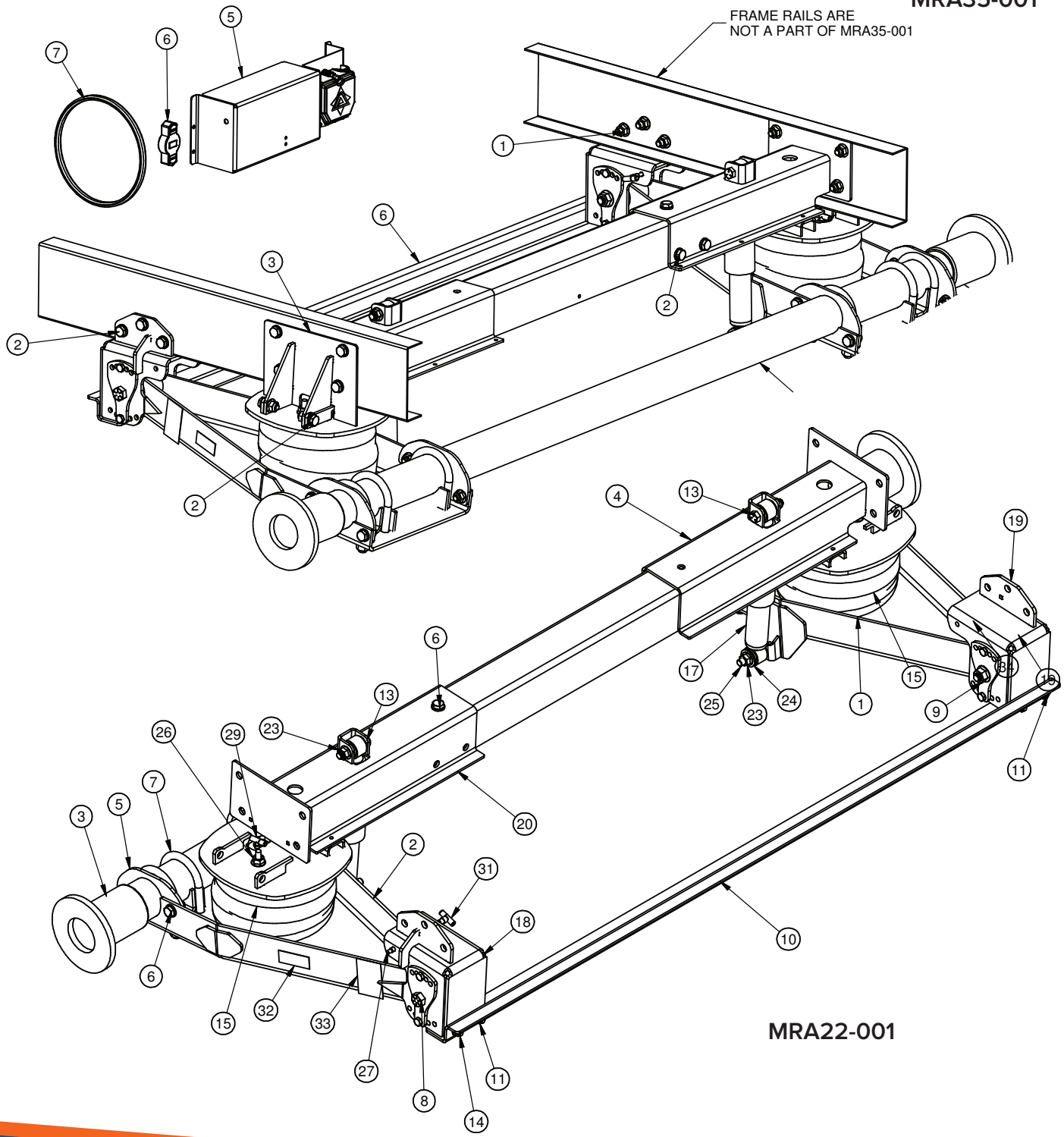

MRA22-001

## INTRODUCTION

The MORryde Air1 system controls air suspension height on your trailer using a remote and/or a mobile app to control air pressure. There are three main components to this system:

### Powerpack

The powerpack communicates wirelessly with the remote and mobile app to control the air pressure in your suspension. It includes the module and compressor and is located on the front crossmember between the A-Arms and behind the battery of the trailer.

### Remote and/or Mobile App

Use the remote and/or mobile app to increase or decrease pressure and otherwise control and troubleshoot the MORryde Air1 system.

### Suspension Height Indicator

The suspension height indicator makes sure the trailer is operating within safe pressure and height zones. This is located on both sides of the air suspension in front of the tire (fig. A). The suspension height indicator points on and around a labeled green zone. When adjusting pressure in the system before towing the trailer, check that the indicators point in the green zone.

**NOTE:** If you lose power, use an external air source to inflate the air suspension through the Schrader valve, indicated in (fig. A) This method can also be used to exhaust and kneel the trailer.

### **⚠ WARNING**

Only tow the trailer when the suspension height indicators are in the green zone. Check the indicators and adjust air pressure as needed before towing the trailer.

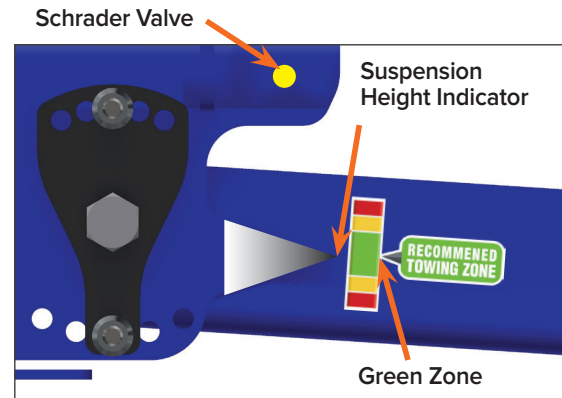

figure A

### Guidelines for Adding or Removing Air Pressure

- 1 When preparing to head out for a drive, make sure the suspension height indicators are in the green zone. Use your remote, mobile app, or Schrader valve to add or remove air as needed.
- 2 When loading or unloading a vehicle into the garage of the trailer, it is recommended to kneel the trailer by exhausting air spring pressure to approximately 5 PSI.
- 3 Increase air pressure in the system to overcome temporary obstacles and raise ground clearance.



Above. Beyond. Always.

# PNEUMATIC PLUMBING DETAILS

## Suspension Plumbing

### Air Hose Line Location: Underneath Unit View

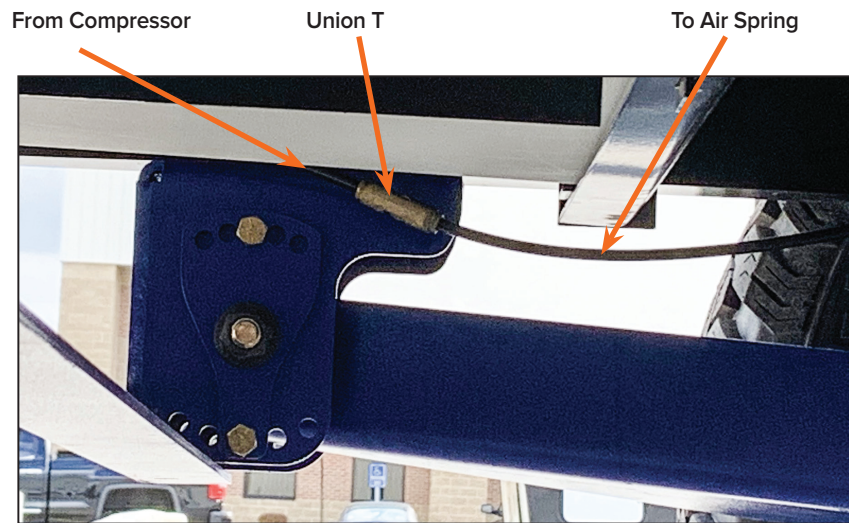

# POWERPACK DETAILS

## Plumbing and Electrical

Powerpack: Back View

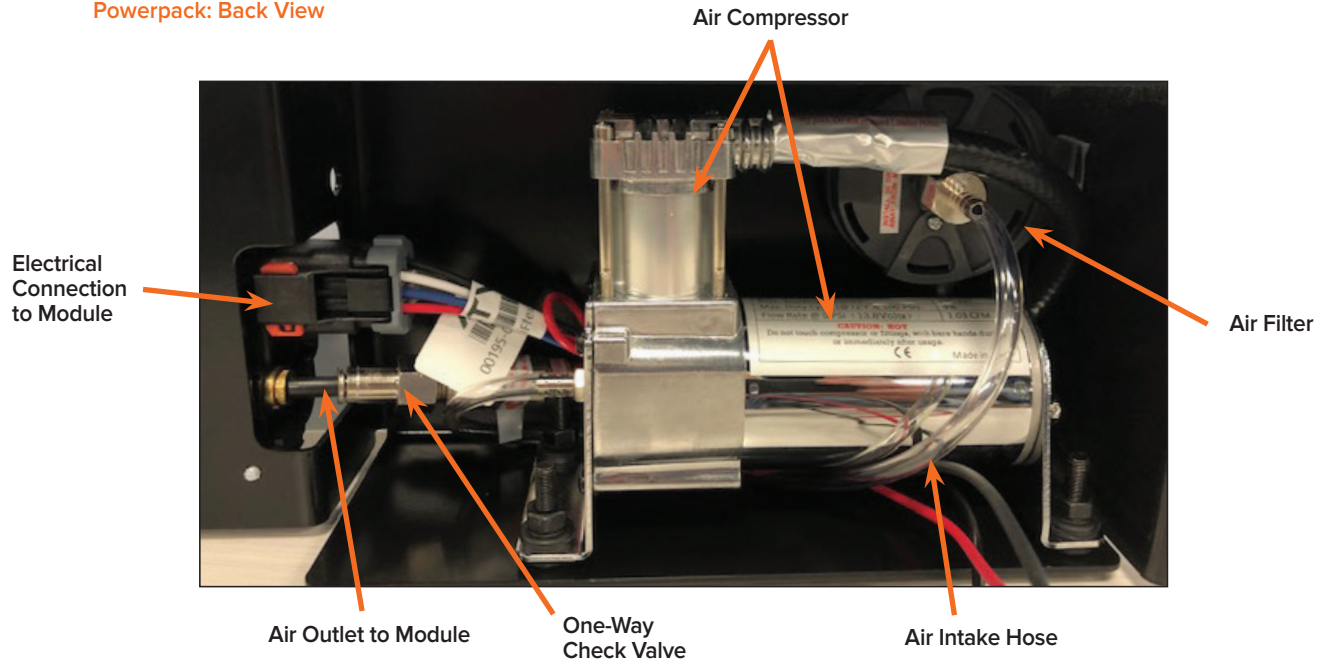

Powerpack: Front View

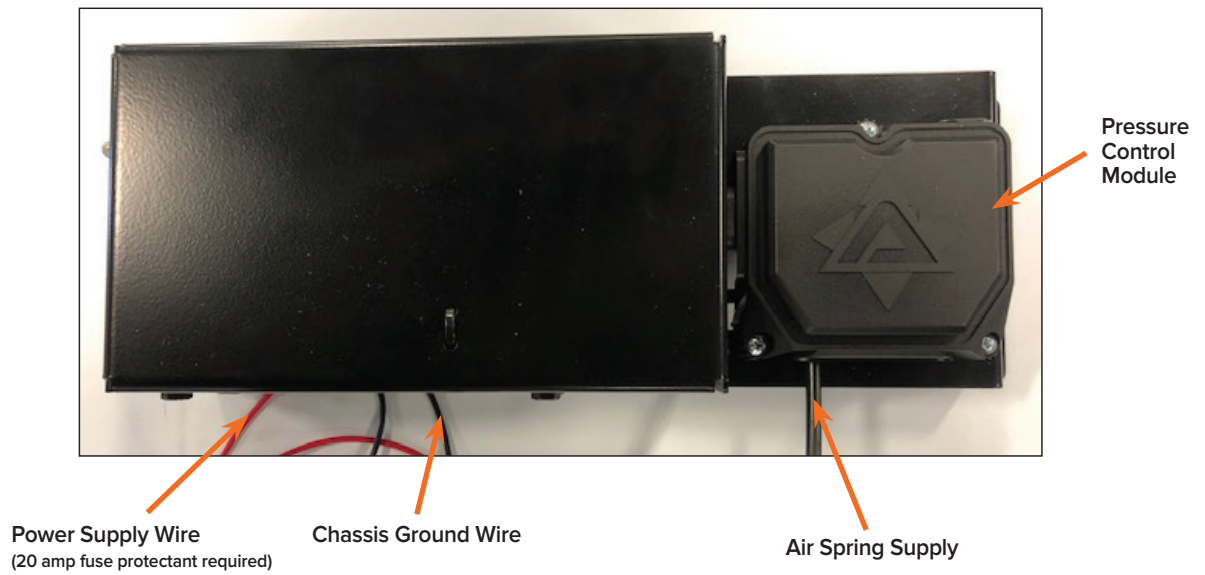

Above. Beyond. Always.

The powerpack is attached onto the front crossmember located between the A-Arms, behind the battery.



## PREPARATION

### Product and Safety Information

#### **⚠ WARNING**

Never kneel or raise the trailer when the StepAbove™ Steps are deployed due to risk of property damage and/or personal injury.

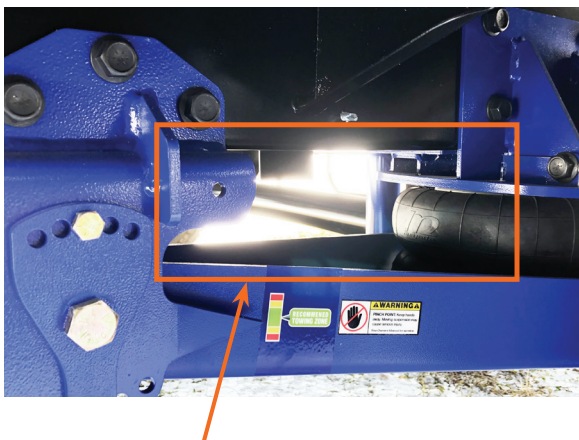
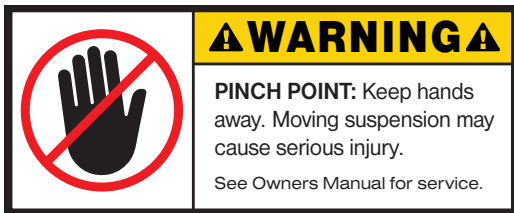

Don't place hands in this area

#### **⚠ WARNING**

Failure to follow the instructions and heed the warnings of this manual may result in death or serious injury, damage to the vehicle and/or trailer, and/or voidance of the product warranty. Always utilize appropriate personal safety equipment, i.e. proper eye protection, hearing protection, gloves, etc.

#### **⚠ WARNING**

When working under the trailer, adequately support the unit at the trailer frame and deploy the stabilizer jacks. Do **NOT** kneel the trailer when working under it. Securely block all trailer wheels when the unit is disconnected from the towing vehicle. All work should be done on level ground.

## Use of Manual

### Dealer

- Provide Manual to end user

### End User

- Read and follow Manual with each use of the MORryde Air1 Suspension System
- Save Manual for future reference
- Provide Manual to other users or future owners of the MORryde Air1 Suspension System

### **⚠ WARNING**

Failure to follow all of these instructions may result in serious injury or death.

## Compatibility

- The system uses a 12v compressor. Contact MORryde for correct replacement if necessary.
- Use the correct size ball for the trailer coupler and prior to hitching and towing, ensure compatibility.

## Pretravel Inspection

Prior to each tow, complete a pretravel inspection and walk-around of the trailer and towing equipment.

- Inspect the condition of all towing equipment. Make any repairs or replacements necessary.
- Inspect the condition and torque of all bolts.
- Check that the suspension height indicator is in the green zone on both sides of the trailer.

### **⚠ WARNING**

Follow all hitching and towing specifications of the trailer and towing equipment manufacturers. You are personally responsible for safe hitching and unhitching, loading and unloading, and towing and driving practices.

## Tow Rating Checks

### **⚠ WARNING**

Failure to verify and follow tow ratings may result in damage to the tow vehicle or trailer during transit. The trailer and its contents must not exceed truck, hitch, and/or trailer tow ratings.

### Do NOT Exceed

- Towing vehicle manufacturer's ratings
- Hitch manufacturer's ratings
- Trailer manufacturer's ratings
- Trailer coupler manufacturer's ratings

### **⚠ WARNING**

Follow all trailer manufacturer's specifications for safe loading/unloading of trailer.



Above. Beyond. Always.

System Mobile App

# MORryde Air1

USER GUIDE



## REMOTE

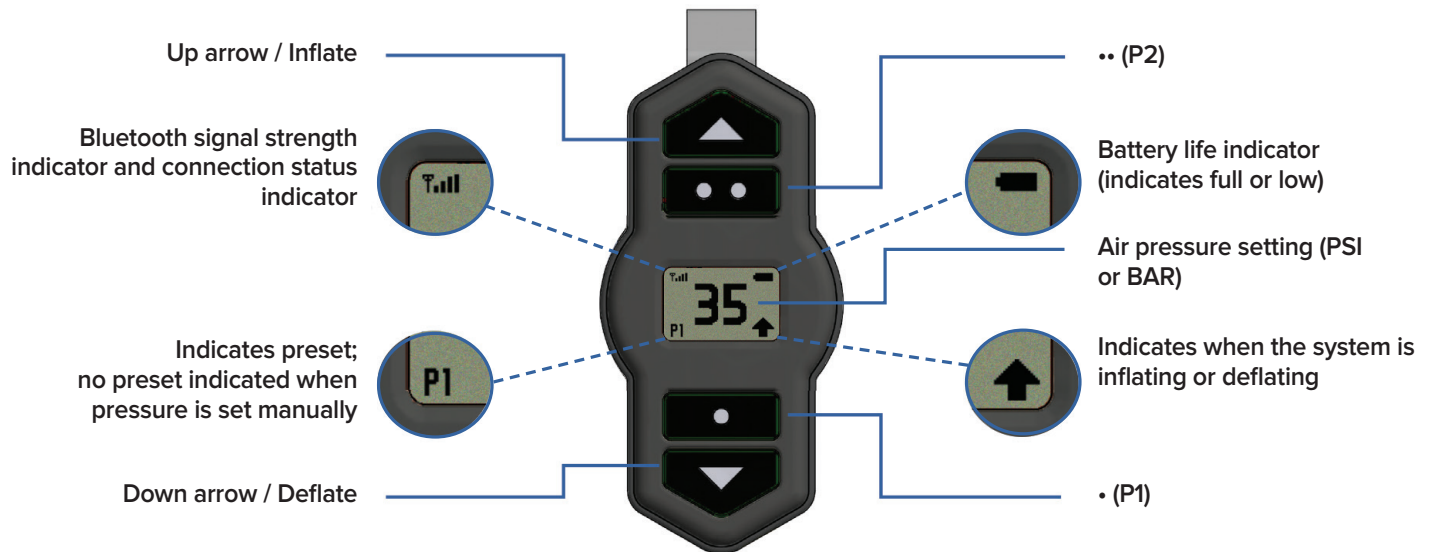

figure 1

### Operation

#### STEP 1

Push a button to wake up the remote, which will display the target pressure.

#### STEP 2

Press the up/down arrows to raise/lower the pressure in increments of 1 PSI (0.1 BAR).

**NOTE:** Maximum pressure is 80 PSI (5.5 BAR).

**NOTE:** To enter the menu, press the inflate and deflate buttons at the same time (fig. 1).

### Backlight

The remote display stays on for 40 seconds. The backlight automatically dims after 2 to 10 seconds depending on battery condition, then goes off after an additional 30 seconds. Press any button to wake up the remote.

Max. Pressure:  
80 PSI (5.5 BAR)

Min. Pressure:  
5 PSI (0.34 BAR)



Above. Beyond. Always.

## Pair the Module to the Remote

The module will enter pairing mode for three minutes after the fuse is installed. Once a device is paired, it will automatically connect if no other device is already connected. The remote will go into sleep mode after 40 seconds, at which time it will disconnect from the system.

**NOTE:** The remote comes with batteries installed. To operate the device, slowly pull the tab out of the battery compartment.

### STEP 1

To initiate pairing mode, remove the fuse, wait five seconds, and reinstall.

### STEP 2

Press a button to wake up the remote. It will automatically go to the pairing screen if it is not already paired with a module. Use the up and down arrow buttons to navigate the pairing menu. Select the device that matches the module serial number (figs. 2 & 3).

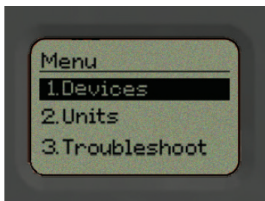

figure 2



figure 3

### STEP 3

Use the up and down arrows to choose the module. Press • (P1) to begin pairing process.

### STEP 4

The device will indicate “pairing” when it is connecting to a device. There is no Bluetooth password.

### STEP 5

Once complete, the remote will either indicate “pairing successful” which means the devices are paired, or “pairing unsuccessful” which will require the user to pull and reinstall the fuse and try again. Once the remote is connected to the module, it will automatically connect each time the module is active and the remote is woken up.

**NOTE:** To enter the menu, press the inflate and deflate buttons at the same time (fig. 1).

## Units

Select "Units" from the menu to switch between PSI and BAR (fig. 4). The factory default is PSI.

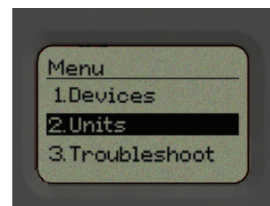

figure 4

## Troubleshoot

Select "Troubleshoot" from the menu to see system error messages. For more information about error messages, review the section in this manual called Troubleshooting Guide.

## REMOTE PRESETS

### STEP 1

Set the pressure to the desired level using the inflate and deflate buttons (fig. 5).

### STEP 2

To set each preset:

Preset 1: Press and hold the • (P1) for 3 seconds.

Preset 2: Press and hold •• (P2) for 3 seconds.

Preset 3: Push and hold the • and •• buttons simultaneously for 3 seconds.

As an example, after setting the desired pressure, press and hold • to set preset 1.

**NOTE:** The remote indicates which preset is currently selected in the lower left corner.

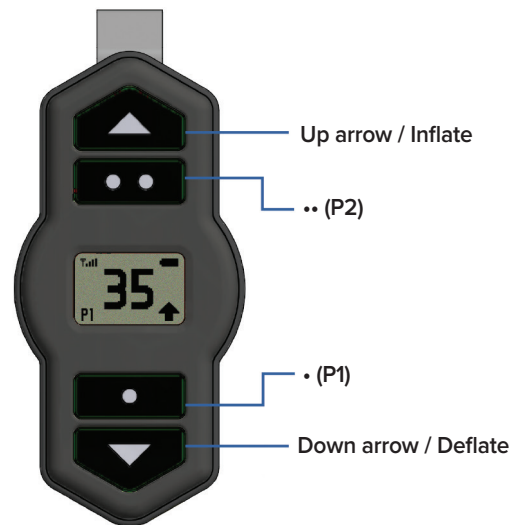

figure 5

## IOS APP

### User Interface Operation

#### STEP 1

Open the app to the user interface. It shows the desired pressure (fig. 6).

#### STEP 2

Press the up/down arrows to inflate/deflate in increments of 1 PSI (0.1 BAR).

#### STEP 3

Click on the gear by each preset to set and name the presets.

#### STEP 4

Click on the air pressure number to manually enter a desired pressure.

Max. Pressure: 80 PSI (5.5 BAR)	Min. Pressure: 5 PSI (0.34 BAR)
------------------------------------	------------------------------------

### USER INTERFACE



figure 6



Above. Beyond. Always.

## Pair the Module to the Mobile App



### STEP 1

Download the free MORryde Air1 app from the Apple App Store for iOS. Search for MORryde Air1.

### STEP 2

Put the module in pairing mode by removing the fuse to the battery and replacing it after five seconds. The module will remain in pairing mode for three minutes after the fuse is reinstalled.

### STEP 3

The app will automatically go to the "Devices" screen if no connected module is detected. Click on the device you want to pair. The module will have MORryde Air1 in the title. Each device also shows the connection status (fig. 7).

**NOTE:** Once the mobile app is paired to the module via Bluetooth, it will connect automatically each time the module is active and the device is in range. Only one device can be connected at a time. To connect another device, the app on any device currently connected must be closed.

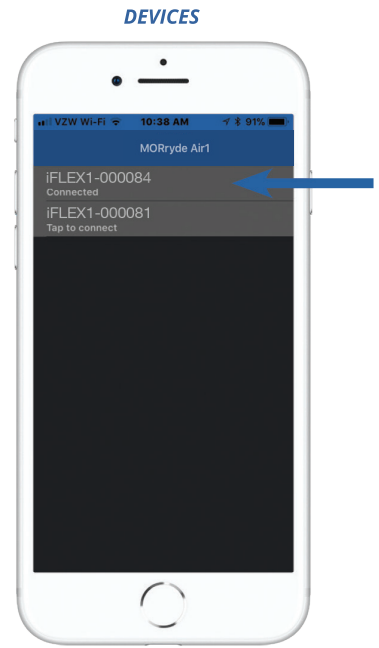

figure 7

### STEP 4

To pair a second mobile device, repeat the procedure on that device. The module can pair with up to 10 mobile devices. One mobile device can pair with any number of modules; there is no limit.

## Settings

### STEP 1

Open the "Settings" screen (fig. 8) to view these options:

#### Devices

- Lists modules that are within range.

#### Troubleshoot

- Displays system error messages  
(See *Troubleshooting Guide* section)

#### Settings

- Pressure control units (PSI or BAR)
- Prevent Screen Lock stops the mobile device screen from going to sleep while the app is open

#### Firmware Update

#### Communicate

- **Online Help**
  - Links to morryde.com
- **About (fig. 9)**
  - Shows app software revision and module firmware revision

### STEP 2

Use the "Done" button to go back to the user interface.

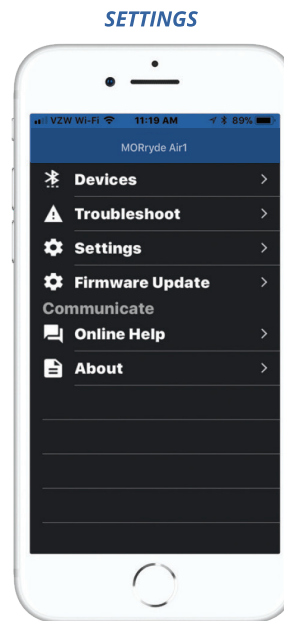

figure 8



figure 9

## App Presets

### STEP 1

Connect the app to the module to change presets (fig. 10). The presets are stored on the module, so changes made in the app will also affect the remote and vice versa.

### STEP 2

Adjust the presets by clicking on the gear by each preset.

### STEP 3

To adjust preset values, click on the name or pressure value and type the desired name and pressure.

### STEP 4

Click “OK” to save the preset or “Cancel” to close the preset screen.

## Firmware Update

### STEP 1

Connect the app to the module to change firmware on the module (fig. 11).

### STEP 2

Update MORryde Air1 app to download the latest firmware for transfer to the module.



figure 10

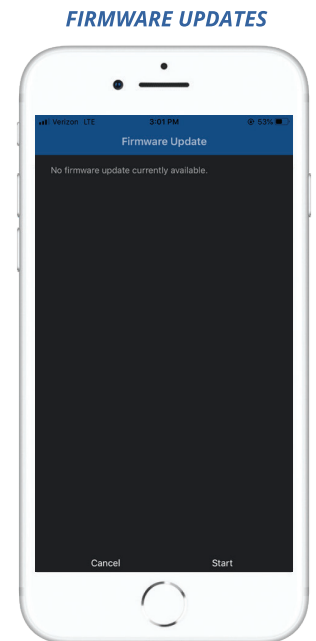

figure 11

## ANDROID APP

## Dashboard Operation

### STEP 1

Open the app to the dashboard. It shows the desired pressure (fig. 12).

### STEP 2

Press the up/down arrows to inflate/deflate in increments of 1 PSI (0.1 BAR).

### STEP 3

Click on the gear by each preset to set and name presets.

### STEP 4

Click on the air pressure number to manually enter a desired pressure.

Max. Pressure: 80 PSI (5.5 BAR)      Min. Pressure: 5 PSI (0.34 BAR)

### USER INTERFACE

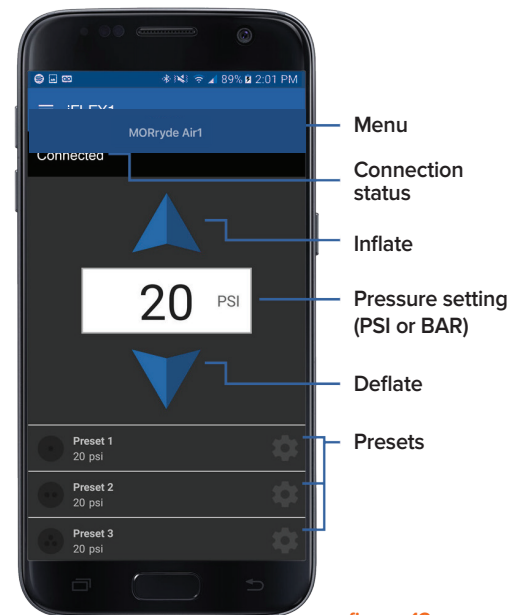

figure 12



Above. Beyond. Always.

## Pair the Module to the Mobile App



### STEP 1

Download the free MORryde Air1 app from Google Play for Android. Search for MORryde Air1.

### STEP 2

Put the module in pairing mode by removing the fuse to the battery and replacing it after five seconds. The module will remain in pairing mode for three minutes after the fuse is reinstalled.

### STEP 3

The app will automatically go to the "Devices" screen if no connected module is detected. Click on the device you want to pair. The module will have MORryde Air1 in the title. Each device also shows the connection status (fig. 13).

**NOTE:** Once the mobile app is paired to the module via Bluetooth, it will connect automatically each time the module is active and the device is in range. Only one device can be connected at a time. To connect another device, the app on any device currently connected must be closed.

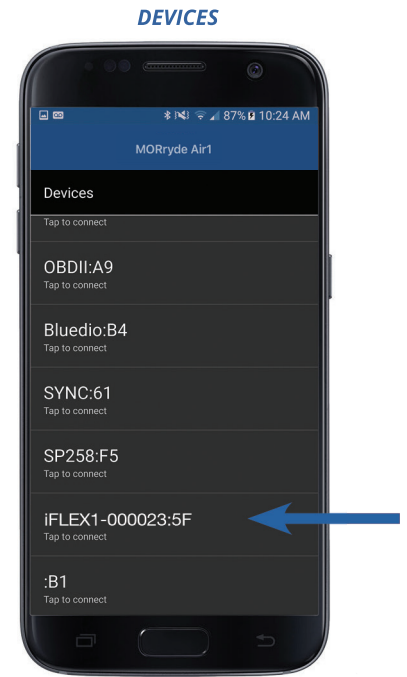

figure 13

### STEP 5

To pair a second mobile device, repeat the procedure on that device. The module can pair with up to 10 mobile devices. One mobile device can pair with any number of modules; there is no limit.

## Navigation/Communicate

### STEP 1

Open the "Navigation/Communicate" screen (fig. 14) to view these options:

#### Navigation

- Dashboard
  - Closes the menu and returns to the dashboard
- Devices
  - Lists devices that are available for pairing
- Troubleshoot
  - Displays system error messages  
(See *Troubleshooting Guide*)
- Settings
  - Pressure control units (PSI or BAR)
  - Prevent Screen Lock stops the mobile device screen from going to sleep while the app is open
- Update Firmware

#### NAVIGATION

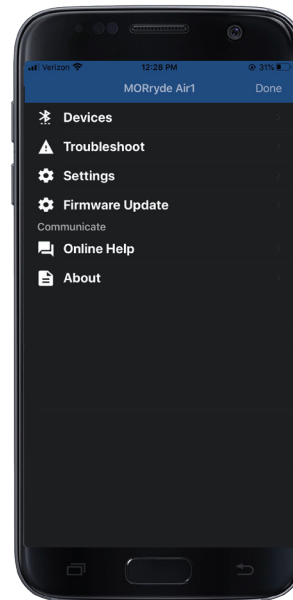

figure 14

#### ABOUT



figure 15

## Communicate

- **Online Help**
  - Links to [morryde.com](http://morryde.com)
- **About (fig. 15)**
  - Shows app software revision and module firmware revision

## STEP 2

Click off of the menu bar or press the back button to return to the dashboard.

## App Presets

### STEP 1

Connect the app to module to change presets (fig. 16). The presets are stored on the module, so changes made in the app will also affect the remote and vice versa.

### STEP 2

Adjust the presets by clicking on the gear by each preset.

### STEP 3

To adjust preset values, click on the name or pressure value and type the desired name and pressure.

### STEP 4

Click "ACCEPT" to save the preset or "CANCEL" to close the preset screen.



figure 16

figure 17

## Firmware Updates

### STEP 1

Connect the app to the module to change firmware on the module (fig. 17).

### STEP 2

Update the MORryde Air1 app to download the latest firmware for transfer to the module.



Above. Beyond. Always.

## MAINTENANCE

- Follow all truck, hitch, coupler, trailer, and axle manufacturers' preventive maintenance recommendations.
- Repaint metal suspension components to prevent rust and maintain its appearance.

**NOTE:** Do NOT paint over labels.

- Periodically check the torque values of all hardware. Torque specifications have been provided on (pg. 3) of this manual.

### Cold Weather Service

It's possible that the valve may freeze when operating in cold weather. A hair dryer can be used to thaw the check valve, see (fig. 18). Injecting airline antifreeze such as ABC Air Brake Conditioner into the system can also be used to thaw the check valve, see (fig. 19). If the trailer is going to be used frequently in cold weather, contact MORryde International for a Cold Weather Kit that can be added to your Single Axle Air Suspension.



figure 18



figure 19

## TROUBLESHOOTING GUIDE

For any issue not listed, contact MORryde Customer Service at 574.293.1581 or [parts@morryde.com](mailto:parts@morryde.com).

Error codes are labeled “Active Errors” and “Dormant Errors” on the app (fig. 20). Active and dormant error codes are indicated by “A” and “D” on the remote (fig. 21).

Use the “CLEAR ERRORS” button to clear current codes and check for presently active codes. Error codes can only be cleared by using the mobile app.



figure 21

Example of an error code on the remote.

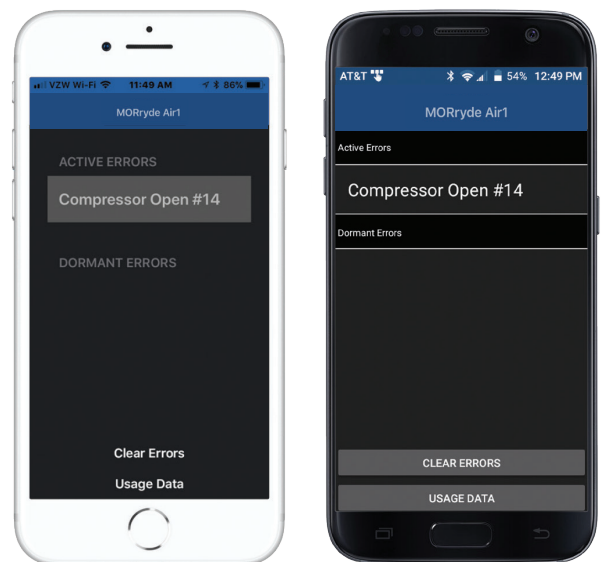
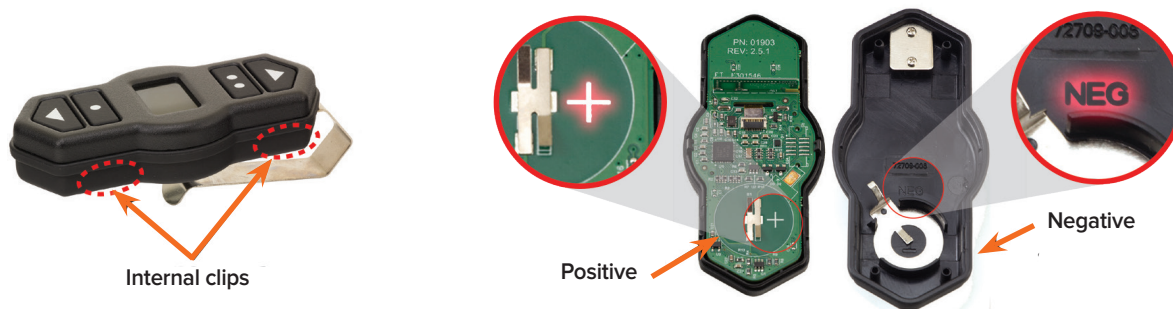

figure 20

Example of error code on the smartphone app for iOS (left) and Android (right).



## Replacing the Batteries in the Remote

### STEP 1

To install the two CR2032 batteries in the remote, use a small flat screwdriver to separate the two halves of the remote by prying apart the internal clip locations.

### STEP 2

Stack the batteries positive to negative inside the rear cover with the positive end pointed in the direction of the circuit board. Take note of “NEG” on the case and “+” symbol on the circuit board.

### STEP 3

Snap the front cover/circuit board onto the rear cover.

## FCC and Industry Canada Information to User

This device complies with Part 15 of the FCC Rules and with Industry Canada license-exempt RSS standard(s). Operation is subject to the following two conditions: (1) This device may not cause harmful interference, and (2) This device must accept any interference received, including interference that may cause undesired operation.

Le présent appareil est conforme aux CNR d'Industrie Canada applicables aux appareils radio exempts de licence. L'exploitation est autorisée aux deux conditions suivantes : (1) l'appareil ne doit pas produire de brouillage, et (2) l'utilisateur de l'appareil doit accepter tout brouillage radioélectrique subi, même si le brouillage est susceptible d'en compromettre le fonctionnement.

**NOTE:** Changes or modifications not expressly approved by the party responsible for compliance could void the user's authority to operate the equipment.

### REMOTE

FCC ID: 2ANLC-OMQ22817

IC: 23130-OMQ22817

### MODULE

FCC ID: 2ANLC-HJL71117

IC: 23130-HJL71117



Above. Beyond. Always.

Problem	Error Code	Cause	Solution
If the ignition wire is not connected, the system will only maintain a preset when the vehicle starts moving or is connected to the remote or mobile app.			
Compressor doesn't run when inflation is commanded	1	Battery voltage is too low (below 9 volts)	Check the batteries.
	2	Battery voltage is too high (above 18 volts)	Check the batteries and charging system.
	3	Module temperature is too cold	Allow module to warm up.
	4	Module temperature is too hot	Allow module to cool down. Move module location away from heat sources.
	15	Compressor overcurrent	Use the mobile app to clear the error code. Disconnect the compressor and test on the bench using 12 volts.
	18	Compressor duty cycle limit has been reached	Allow the compressor to sit idle until the cool down period (15 minutes) has been reached.
	19	Blockage in the compressor or system which is preventing air flow	Check for system blockages or frozen moisture in the air lines. Remove and reinstall the 15A fuse to reset the fault. One mobile device can pair with any number of modules; there is no limit.
-	Bad ground, poor wire connections, bad compressor, or bad module	Clean the ground wire terminal. Disconnect the compressor and test on the bench using 12 volts.	
System does not exhaust when deflation is commanded	1	Battery voltage is too low (below 9 volts)	Check the batteries.
	2	Battery voltage is too high (above 18 volts)	Check the batteries and charging system.
	3	Module temperature is too cold	Allow module to warm up.
	4	Module temperature is too hot	Allow module to cool down. Move module away from heat sources.
Nothing happens when vehicle is turned on	-	If the ignition wire is not connected, the system will only maintain a preset if the truck starts moving or is connected to the remote or mobile app.	Connect the optional ignition wire if desired. Connect to the module using the remote or mobile app to wake the system up for quicker adjustments.
Nothing happens when making an adjustment with the remote	-	When first powering on the remote, the Bluetooth connection is established in the background. Changes to the desired pressure can be made while connecting, but the adjustment command won't be sent until the Bluetooth connection is complete and the signal strength icon is visible in the upper left corner of the screen.	Wait for the Bluetooth connection to complete. The last adjustment will automatically be made once the connection is established.
Unable to connect to the module with the remote	-	Remote batteries are low	Check the remote battery icon. Change the batteries if necessary (See <b>Replacing Batteries</b> ).
	-	Blown 20A fuse	Check the 20A fuse. Enter the pairing screen on the remote or the on the mobile app > Devices and see if the device name (iFLEX#) is visible via Bluetooth.
	-	Weak Bluetooth signal	Ensure the module is mounted forward of the rear axle. Move the module to a location not shielded by metal.
	-	Remote has become unpaired from the module	Re-pair the remote by removing and reinstalling the 20A fuse. The module will be in pairing mode for 3 minutes after power is applied.
System does not maintain and/or reach ride height	21	Large leak in the system	Locate and correct the leak (See <b>Finding Air Leaks and Fixing Leaks in Barbed Fittings</b> and <b>Fixing Leaks on PTC Fittings</b> ). Remove and reinstall the 20A fuse to reset the fault.
	-	The trailer could be overloaded	If the air pressure in the system is at its max pressure of 80 PSI (5.5 BAR), the system will stop inflating.
Compressor runs often without commanding an inflate adjustment	22	Small air leak in the system	Locate and correct the leak (See <b>Finding Air Leaks and Fixing Leaks in Barbed Fittings</b> and <b>Fixing Leaks on PTC Fittings</b> )

## Finding Air Leaks

### STEP 1

Inflate the air springs to 30 PSI (2.1 BAR).

### STEP 2

Spray all connections with a solution of liquid dish soap and water. Wait 30 seconds and check for bubbles, which indicate leaks.

### STEP 3

Check the air pressure again after 24 hours. A 2-4 PSI (0.14-0.28 BAR) loss after initial installation is normal. Retest for leaks if the loss is more than 5 PSI (0.34 BAR).

### STEP 4

After checking for leaks, deflate the springs to the minimum pressure required to restore the system to normal ride height.

## Fixing Leaks on Barbed Fittings

### STEP 1

If there is a leak at the Schrader valve, tighten the valve with a valve core tool.

### STEP 2

If there is a leak at any barbed fitting, cut the air line 1 1/2" (38mm) behind the fitting. Use a pair of pliers or locking pliers to twist and pull the air line off the fitting. Do not cut the air line lengthwise at the fitting because this could nick the barbs, likely causing a leak.

### STEP 3

Reinstall the air line and air line clamp if the fitting has one. Make sure the air line covers all barbs.

## Cutting Air Lines

When cutting air lines, use a sharp knife or hose cutter and make clean, square cuts. Do not use scissors or wire cutters because these tools will deform the air line, causing it to leak around fittings. Do not cut lines at an angle.

The maximum bend radius for a 1/4" air line is 1" (25mm). Do not bend the air line more than the maximum bend radius or side load the fitting connections. Air lines are to be installed straight into fittings.



Above. Beyond. Always.

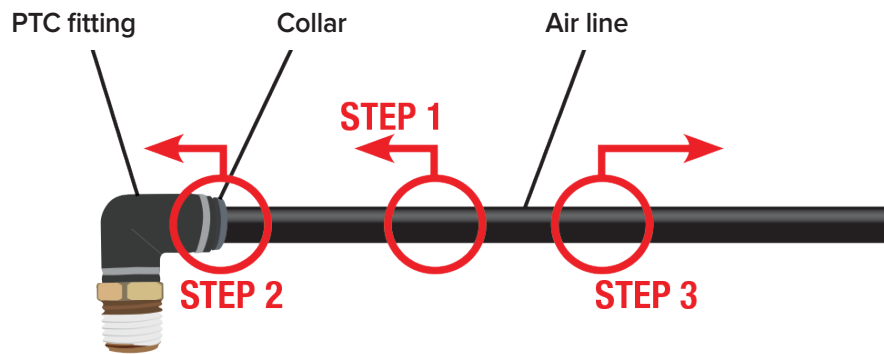

## Fixing Leaks on PTC Fittings

### STEP 1

After insertion, check the PTC fitting connection by pulling on each line to verify a robust connection.

### STEP 2

To release the air line from the connection, first release all air from the system. Push in on the air line (STEP 1), push the collar in (STEP 2), and with the collar depressed, pull the air line out of the fitting (STEP 3).

### STEP 3

To reconnect, push the air line into the fitting and pull to verify a robust connection.

### Tips

- To ensure a proper seal, cut off the end of the air line just beyond the witness mark before reinstalling in the fitting.
- If the fitting is leaking at the threads, it may be necessary to remove and reapply thread sealant on the threads and reinstall 1 1/2 turns beyond finger tight.

## Manual Control Using the Schrader Valve

If electrical power is lost or the system is inoperable, the suspension air springs can be inflated through the suspension-mounted Schrader valve using an external air supply (gas station air or external air compressor). Inflate to achieve the green zone suspension height before towing. Depress the Schrader valve to deflate and reduce height.

### Tools Required:

- 9/16" wrench and socket
- 15/16" wrench and socket
- 1" open-end wrench
- Drift pins
- Torque wrench

## Axle Thrust Adjustment

To adjust the axle thrust, rotate the axle thrust adjustment plates. This repositions the axle pivot bolt. The standard positions for the bolts securing the axle thrust adjuster plates to the pivot bracket are 12 and 6 o'clock (**Center Position**). This orientation positions the axle pivot bolt in the center of the pivot bracket's horizontal slot.

The upper bolt securing the axle thrust adjuster plate will always remain at 12 o'clock. Each hole adjustment will reposition the axle pivot bolt 3/32" or 0.094". For example, with the upper 3/8" bolt at 12 o'clock and the lower bolt at 7 o'clock (**Forward Position**), the axle will shift 3/16".

A total of 3/8" of thrust adjustment is possible when the thrust adjuster plates of one pivot bracket are in the forwardmost position and the opposite side are in the rearmost position.



Above. Beyond. Always.

## To Adjust the Axle Thrust

### STEP 1

Using alignment equipment, determine which side of the axle should be repositioned.

### STEP 2

Empty the air out of the suspension system with the Schrader valve, remote, or app.

### STEP 3

As determined in Step 1, remove the (4) 3/8-16x1" bolts securing the axle thrust adjuster plates to the axle pivot bracket.

### STEP 4

Loosen the 5/8-11 nut securing the suspension arm pivot bolt.

### STEP 5

Reposition the axle thrust adjuster plates. To rotate and properly locate the axle pivot bolt, slide a 1" wrench onto the bottom of the axle thrust adjuster plate. Use drift pins to align the holes for the 3/8" bolts.

### STEP 6

Secure the axle thrust adjuster plates by reinstalling the (4) 3/8-15x1" bolts.

### STEP 7

Retighten the 5/8-11 axle pivot bolt nut.

### STEP 8

Retorque the bolts; see torque chart for specifications.

### Center Position

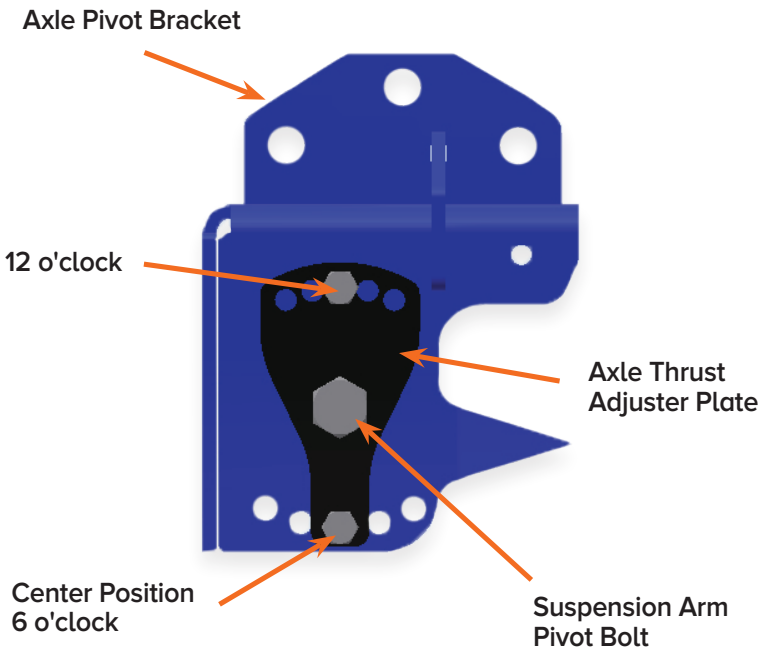

### Forward Position

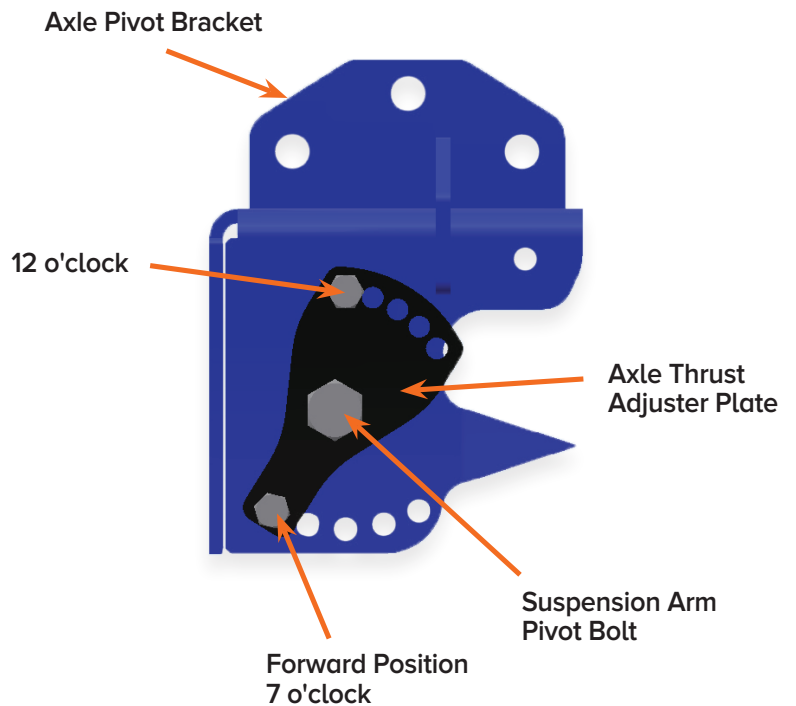

## Flat Tire Change Procedure

### Coupled to a Tow Vehicle:

#### STEP 1

Set the tow vehicle's parking brake.

#### STEP 2

Break loose the lug nuts on the wheel to be changed.

#### STEP 3

Raise the flat tire slightly off of the ground using a scissor or bottle jack. Raise the trailer just enough to remove the tire. Be sure the tire will rotate freely and the hub is far enough off the ground so the replacement tire will fit. See appropriate locations for jack placement.

#### STEP 4

Remove lug nuts securing the flat tire to the hub.

#### STEP 5

Remove the flat tire.

#### STEP 6

Install the spare tire onto the hub.

#### STEP 7

Install and tighten the lug nuts.

#### STEP 8

Lower the trailing arm and remove the jack.

#### STEP 9

Install the lug nuts and tighten in a star pattern.

#### STEP 10

Torque the lug nuts to the manufacturer's recommendations.

#### STEP 11

Verify and adjust tire pressure as required.

### Uncoupled from a Tow Vehicle:

#### STEP 1

Position the trailer on level ground.

#### STEP 2

Use wheel chocks to block the tire/tires that will not be changed.

#### STEP 3

Lower the stabilizer and tongue jack.

#### STEP 4

Break loose the lug nuts on the wheel to be changed.

#### STEP 5

Raise the flat tire slightly off of the ground using a scissor or bottle jack. Raise the trailer just enough to remove the tire. Be sure the tire will rotate freely and the hub is far enough off of the ground so the replacement tire will fit. See appropriate locations for jack placement under trailing arm.

#### STEP 6

Remove lug nuts securing the flat tire to the hub.

#### STEP 7

Remove the flat tire.

#### STEP 8

Install the spare tire onto the hub.

#### STEP 9

Install and tighten the lug nuts.

#### STEP 10

Lower the trailing arm and remove the jack.

#### STEP 11

Torque the lug nuts to the manufacturer's recommendations.

#### STEP 12

Verify and adjust tire pressure as required.



Above. Beyond. Always.

Bottle Jack



Scissor Jack



Lug Nut Star Pattern (5-Bolt)

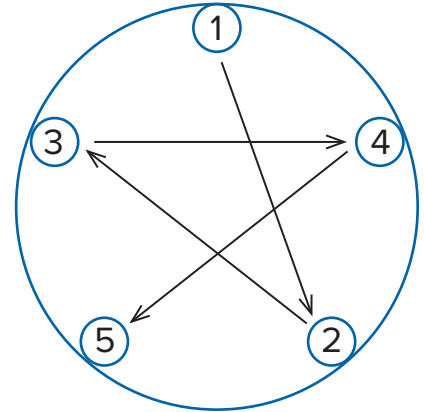

## Installing Wheel Covers

### STEP 1

Elevate the trailer.

### STEP 2

Place wheel covers over tires. The additional clearance makes this easier.

### STEP 3

Kneel the trailer.



### YouTube Video Suggestions

For help or how-to videos, search MORryde's YouTube channel.

### General Operation of Remote and App

Need help? AKTV8 can be reached at 888.342.3162 or visit the website at <https://aktv8.com/contact-us>.

### Limited Warranty and Return Policy

For additional warranty information visit [www.MORryde.com](http://www.MORryde.com) or contact MORryde Customer Service.

### Replacement Parts Information

Contact MORryde's Customer Service at 574.293.1581:

- If parts are incorrect or missing.
- For technical assistance on installation or operation.
- If parts are broken or defective.
- For warranty claims or questions.

Contact Dexter Axle:

- For questions on replacement parts relating to the axle.  
Contact [information@dexteraxle.com](mailto:information@dexteraxle.com) or 574.295.7888

### Contact Information

#### Mailing address

1966 Sterling Avenue  
Elkhart, Indiana 46515-0579

#### Phone

574.293.1581

#### Email

[parts@morryde.com](mailto:parts@morryde.com)

#### Web address

[www.morryde.com](http://www.morryde.com)



1966 Sterling Avenue

Elkhart, Indiana 46516

574.293.1581

[parts@morryde.com](mailto:parts@morryde.com) | [www.morryde.com](http://www.morryde.com)