

Trail Kitchen Accessory: **JP54-076**

ADJUSTABLE TRAIL KITCHEN ENCLOSURE

INSTALLATION INSTRUCTIONS

Designed to be used with the JP54-038 and JP54-060 Trail Kitchens



STEP 1

Place your cooler/freezer on to the Trail Kitchen Base (JP54-038 or JP54-060). Measure from:

- The bottom of the cooler/freezer to the bottom of the freezer handle.
- The bottom of the cooler/freezer to the top of the lid.
- Note these measurements as they will be used in determining the placement of your freezer cover support strap (#4 on the diagram*) and your adjustable freezer cover top (#2 on diagram).

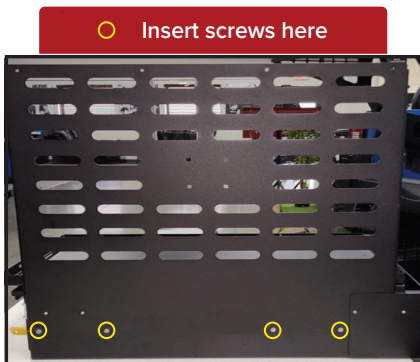

STEP 2

Using (4) Cap Screws and Nylock Nuts (#5 and 6 on diagram), affix the *Freezer Cover Molle Grid Side* (#1 on diagram) to the right side of the Trail Kitchen Base using the recommended wrench socket and allen wrench.

*Product diagram on opposite page, for reference.

Tools Needed:

- 3/8" Wrench/Socket
- 1/8" Allen Wrench
- Measuring Tape

PARTS LIST:

- JP209-180 Freezer Cover - Side w/ Molle Grid
- JP209-181 Freezer Cover - Top
- JP209-182 Freezer Cover - Side
- JP209-183 Freezer Cover - Support Strap
- UO115-345 #10-24 x 7/16 Button Head Cap Screw
- UO116-105 #10-24 Nylock Locknut



Product Dims: 16 5/16" W x (17 3/4" - 20 3/4") H

MORryde

HEAVY. DUTY. ADVENTURE.

www.MORryde.com • 574.293.1581

ADJUSTABLE TRAIL KITCHEN ENCLOSURE

INSTALLATION INSTRUCTIONS



STEP 3

Using (4) Cap Screws and Nylock Nuts (#3 on diagram), affix the *Freezer Cover Side* to the left side of the Trail Kitchen Base using the same tools.

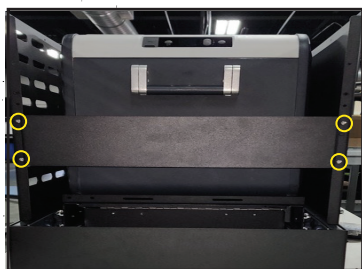

STEP 4

Using (4) Cap Screws and Nylock Nuts, affix the *Freezer Cover Support Strap* to the back side of the Trail Kitchen Enclosure.

Note: the strap should mount just below the bottom of your cooler/freezer handle.

STEP 5

Use the (8) remaining Cap Screws and Nylock Nuts to affix the *Freezer Cover Top* to the two *Freezer Cover Side Panels*.

Note: there are four holes vertically spaced one inch apart to adjust the enclosure top panel. Ensure that the bottom of the panel is higher than the top of your cooler/freezer.



*Product diagram

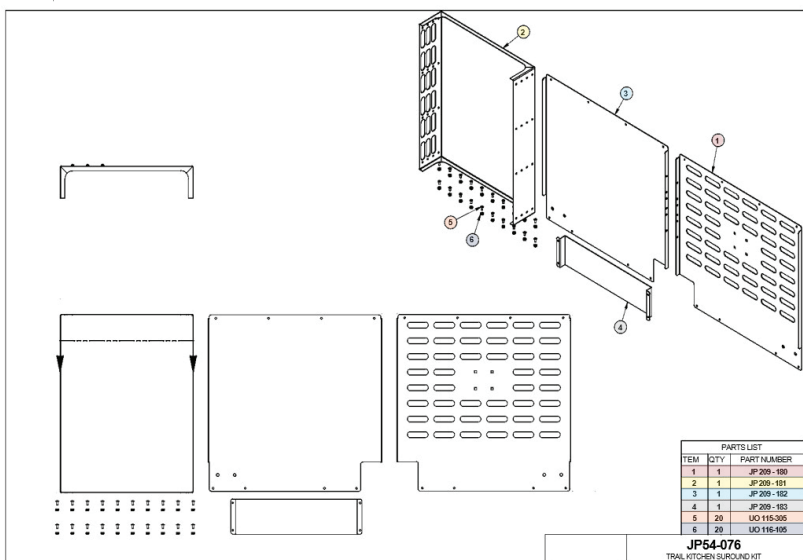

If you have any questions regarding the installation procedure or have difficulty with any of the steps, please contact us at **574-293-1581** or email sales@morryde.com.